

Poly V-belt drive - exploded view of components

1 - Poly V-belt

- ❑ Check for wear
- ❑ Before removing, mark direction of rotation with chalk or felt-tipped pen. If the belt runs in the opposite direction when it is refitted, this can cause breakage.
- ❑ Removing and installing → **Chapter**
- ❑ When installing, make sure it is properly seated on pulleys.

2 - 20 Nm + 90° (1/4 turn) further

- ❑ Renew

3 - 22 Nm

4 - Alternator

- ❑ Removing and installing → **Rep. Gr.27**

5 - Cover cap for idler roller

6 - Idler roller for poly V-belt

- ❑ Tighten to 40 Nm

7 - 20 Nm

8 - Poly V-belt pulley for coolant pump

- ❑ Removing and installing → **Chapter**

9 - 9 Nm

10 - Coolant pump

- ❑ Removing and installing → **Chapter**

11 - Cover cap for tensioner

12 - Poly V-belt tensioner

- ❑ Tighten to 40 Nm

13 - 20 Nm

14 - 20 Nm

15 - Bracket for power steering pump

16 - 20 Nm

17 - Power steering pump

- ❑ Removing and installing → **Rep. Gr.48**

18 - 20 Nm

19 - Poly V-belt pulley for power steering pump

- ❑ Removing and installing

20 - 20 Nm

21 - 25 Nm

22 - Air conditioner compressor

- ❑ Do not unscrew or disconnect refrigerant hoses or pipes.
- ❑ Removing and installing → **Rep. Gr.87**

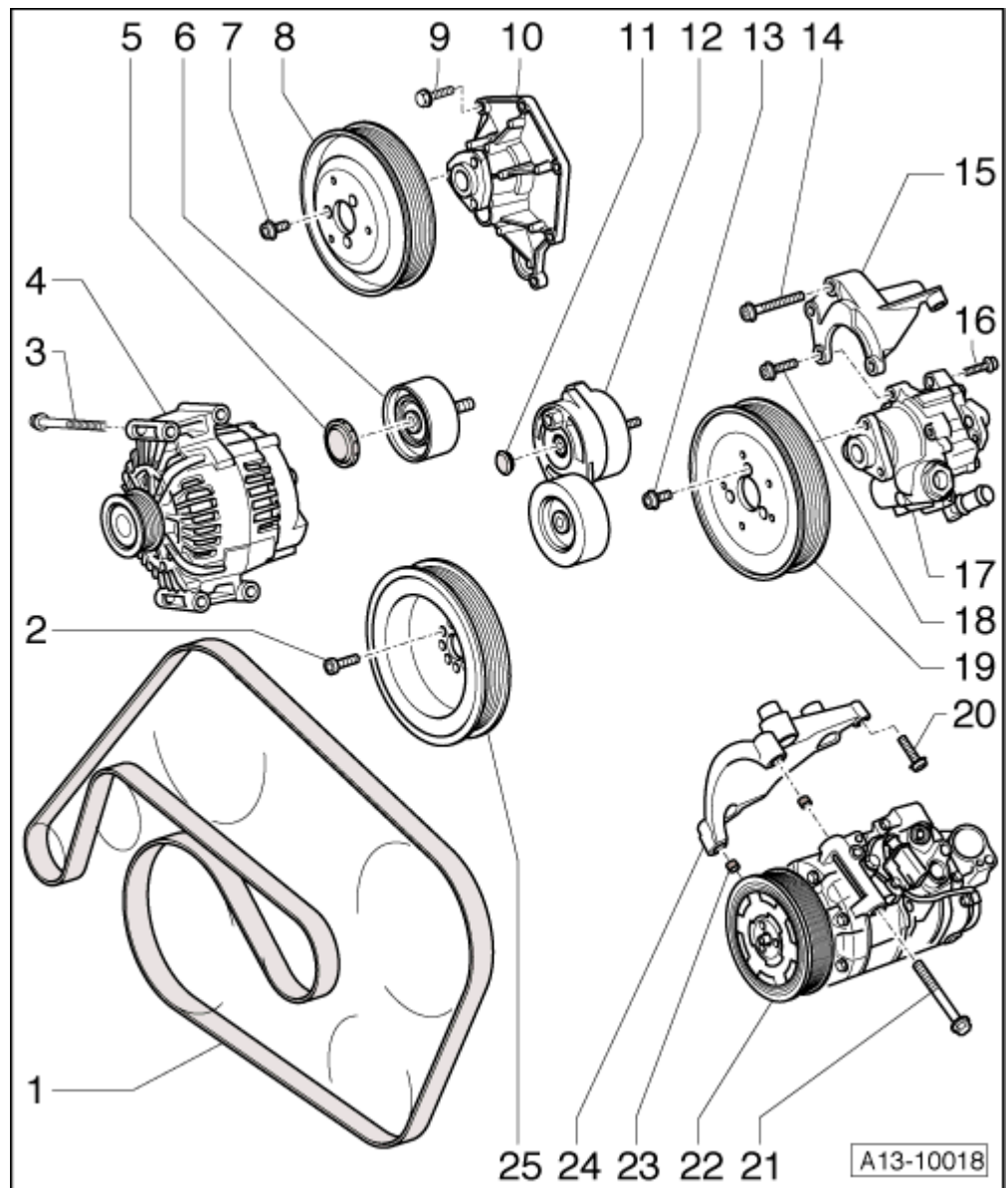

- Pay attention to dowel sleeves → **Item** when installing

23 - Dowel sleeve

- 2x

24 - Bracket for air conditioner compressor

- Pay attention to dowel sleeves → **Item** when installing

25 - Poly V-belt pulley for crankshaft

- Removing and installing → **Chapter**

Все данные взяты с сайта superetka.com/elsa и они полностью бесплатны