

Removing and installing front ashtray (vehicles with “chorus” and “concert” radio)

- Unclip cover panel → Chapter.
- Unclip centre console insert -2- → Chapter.
- Open ashtray (front).
- Unscrew bolt -1- (2x), tightening torque 2 Nm.

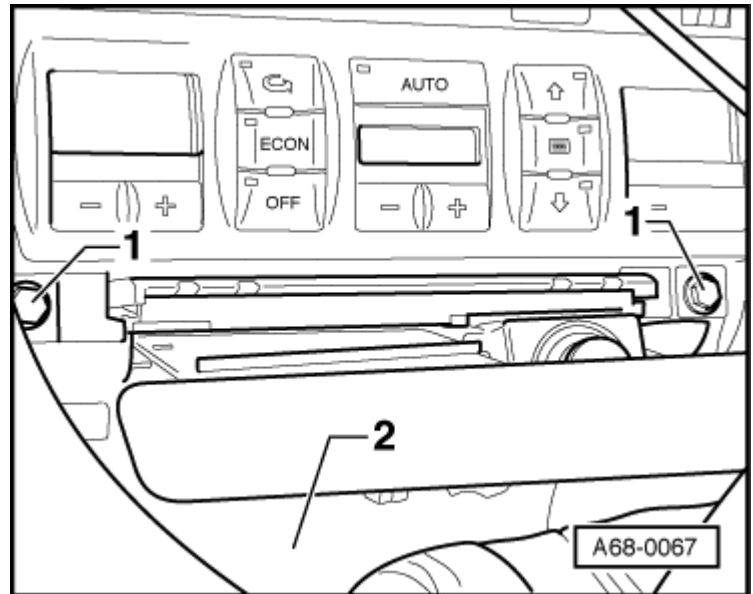

- Use screwdriver -2- to pull out retaining tabs -1- on left and right in direction of arrow.
- Carefully pull air conditioner control panel slightly to rear and pull out ashtray downwards and to rear.
- Pull ashtray to rear and disconnect cables for cigarette lighter and ashtray illumination.

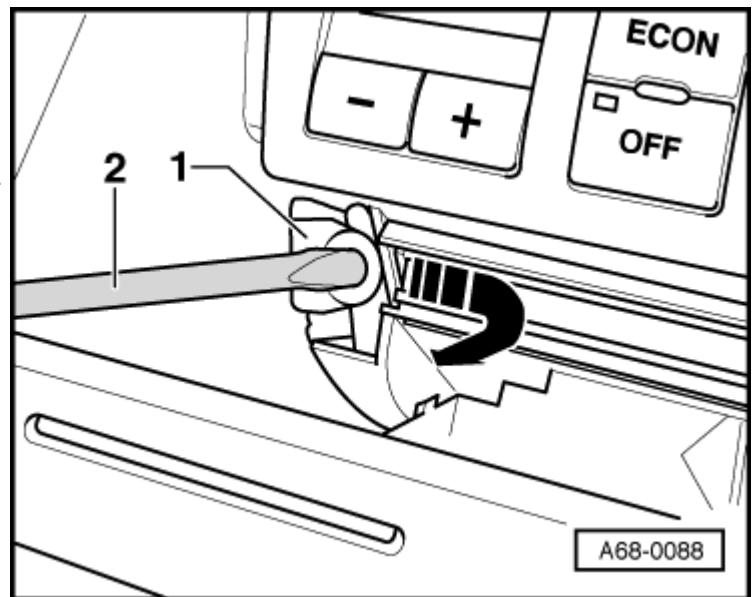

- On installation, make sure guide -1- engages on left and right in centre console.

