

## Dismantling and assembling engine Ribbed belt drive for vane pump, alternator and viscous fan

### Note:

Mark the running direction with chalk or felt pen before removing the ribbed belt. If the belt runs in the opposite direction when it is refitted, this can cause breakage.

1. **Fan wheel**
  - For viscous fan
  - "FRONT" marked on outer race must point in direction of travel
  - Removing and installing =>Page [19-20](#)
2. **Viscous coupling**
  - Switching temperature: 72...80°C ambient temperature at the viscous coupling
  - Checking => Page [19-23](#)
  - Removing and installing =>Page [19-20](#)
3. **Ribbed belt**
  - Check for wear
  - Do not kink
  - Removing and installing =>Page [13-8](#)
  - Routing of ribbed belt=>Fig.[13-7](#)
  - Ribbed belt on vehicles with air conditioner=>Fig.[13-7](#)
4. **20 Nm**
  - To release and pick up pulley counterhold with oil filter strap wrench if necessary.
5. **Hexagon flange**
  - For turning the engine by hand using wrench 32 A/F

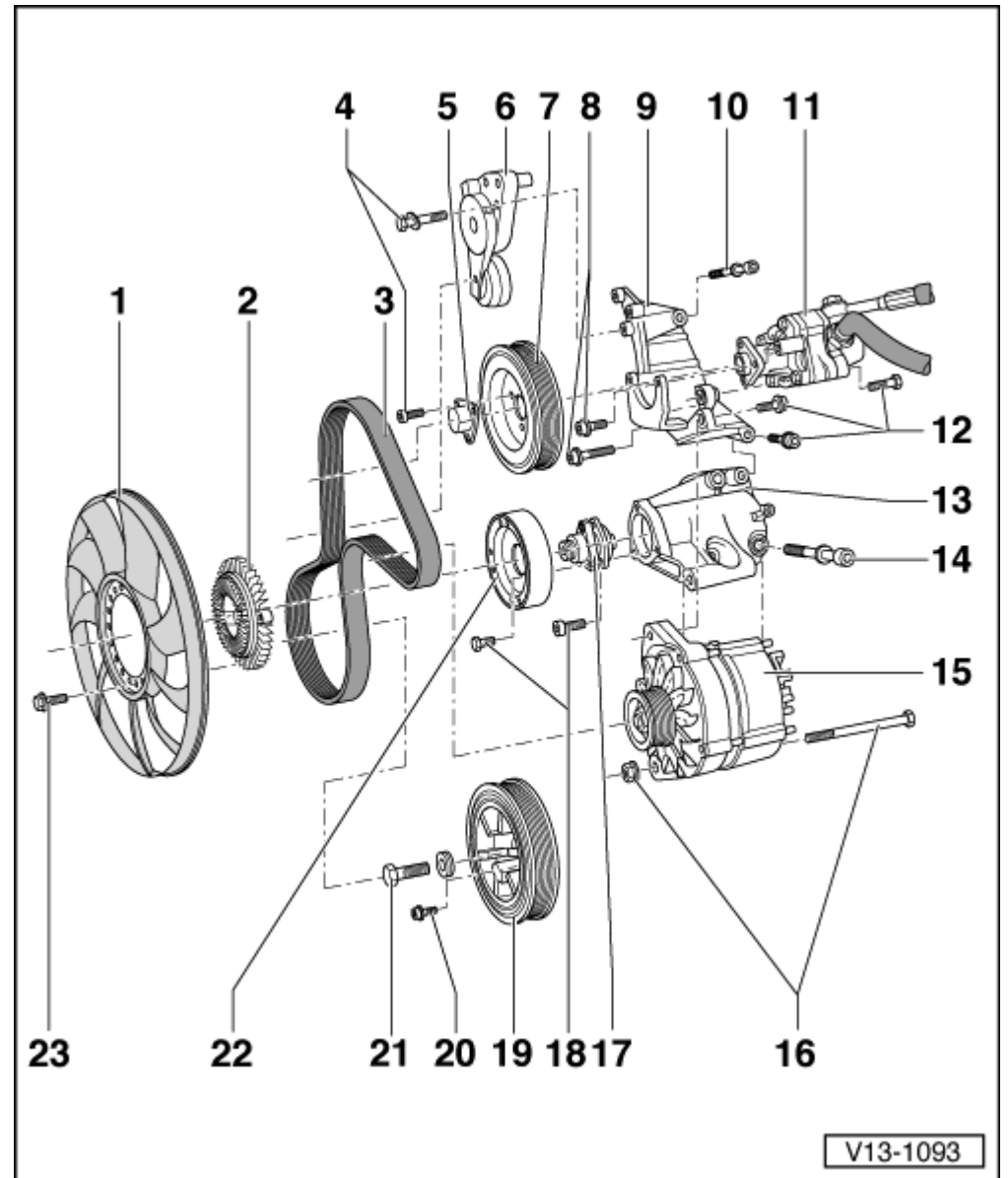

6. **Tensioner for ribbed belt**
  - Swivel with open-ended spanner to slacken ribbed belt => Page [13-8](#)
  - Secure in position with mandrel 3204
7. **Belt pulley**
  - For vane pump
8. **20 Nm**
9. **Bracket**
  - For vane pump
10. **20 Nm**
11. **Vane pump**
  - For power steering
  - Removing and installing:

=> FWD and 4WD Running Gear; Repair group 48; Exploded view: Vane pumps

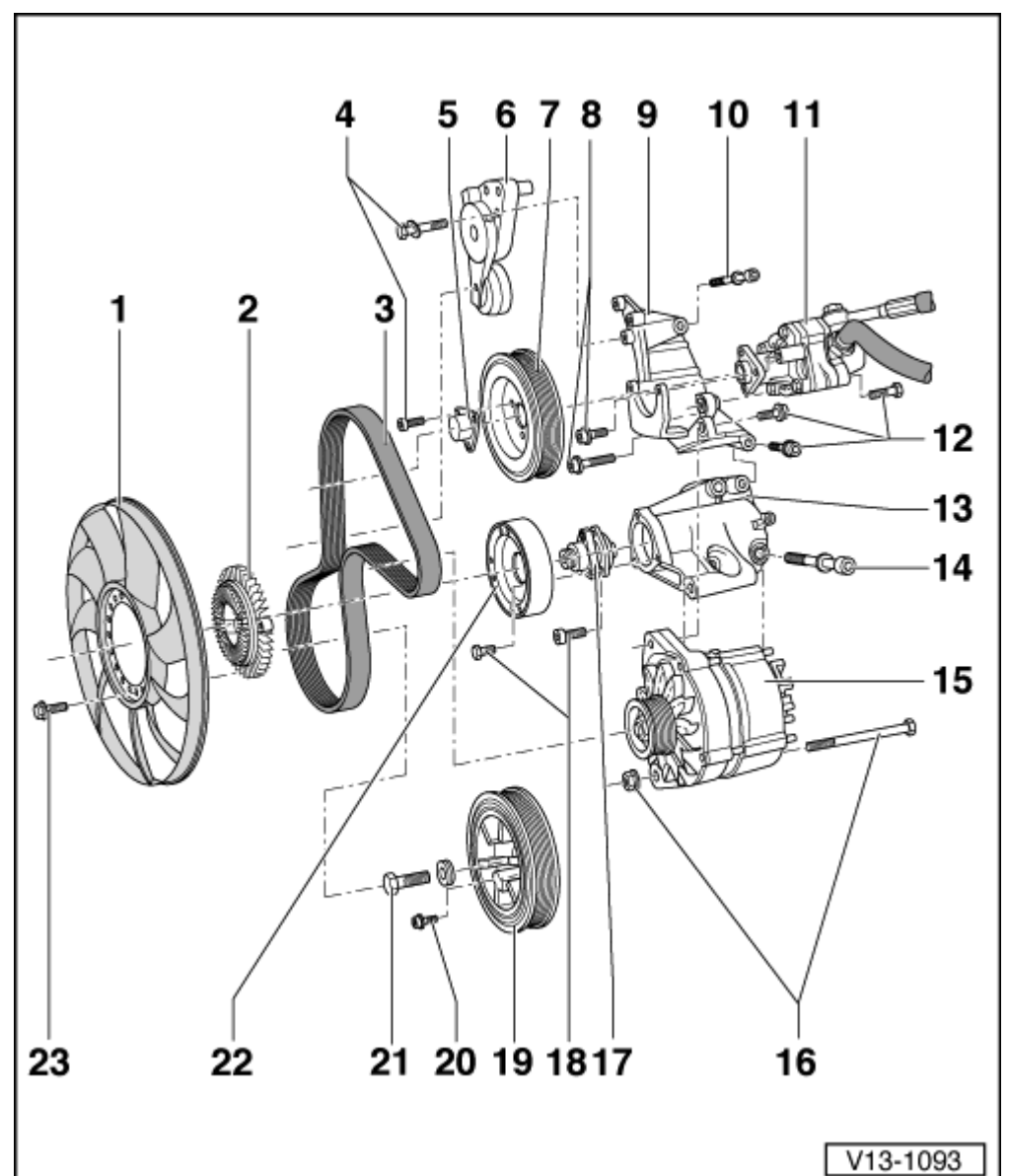

12. 20 Nm

13. Bracket

- For alternator

14. 45 Nm

15. Alternator

- Removing:
- Disconnect battery earth strap
- Removing ribbed belt =>Page [13-8](#)
- Disconnect wiring from alternator
- Unplug connector, lay the wiring aside.
- Unscrew bolts from top and bottom from bracket.
- Remove alternator
- To facilitate attachment of the alternator drive back bush for lower securing bolt slightly at bracket

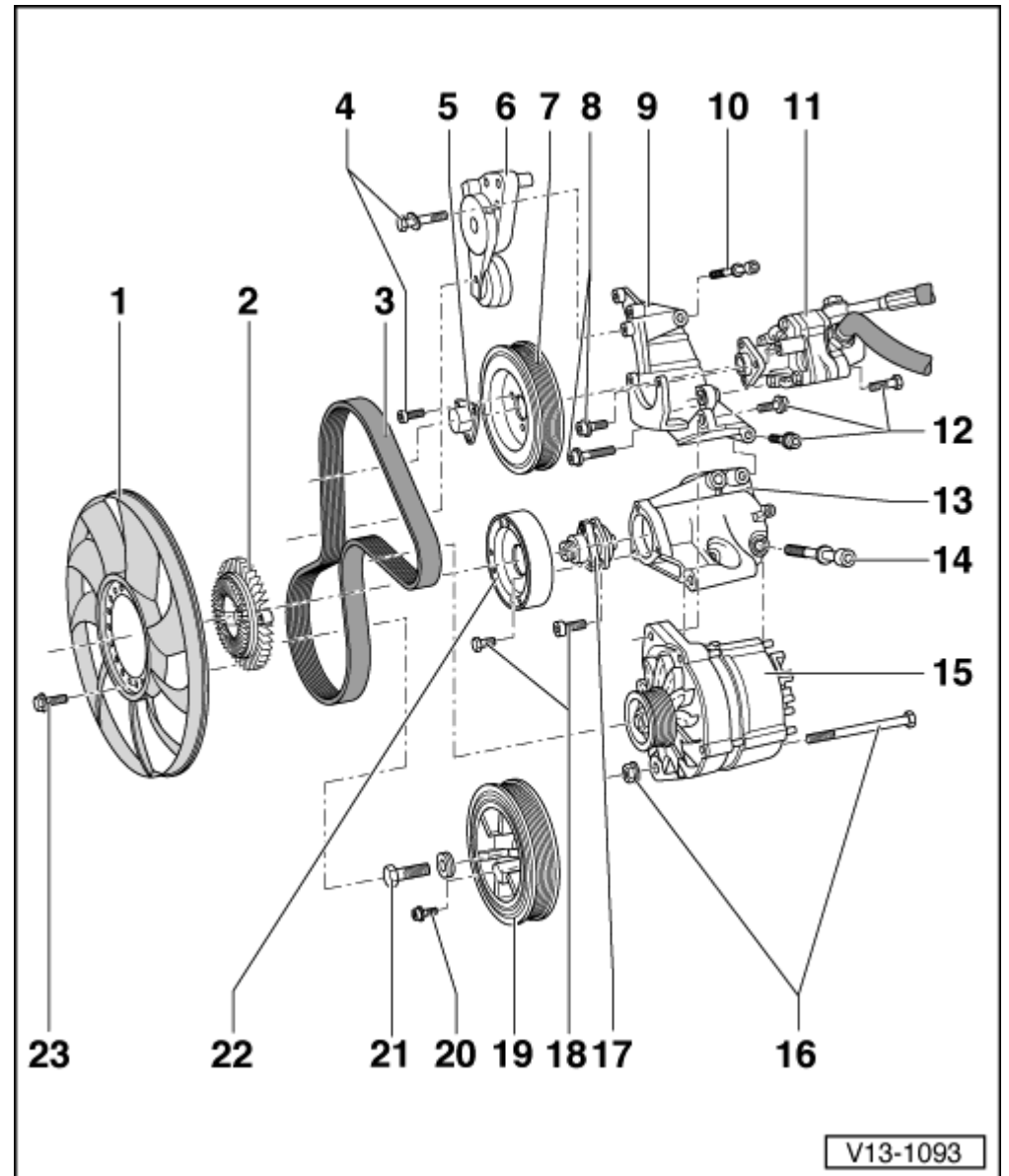

16. 45 Nm

17. Mounting

- For viscous fan
- Check for ease of movement
- Removing and installing =>Page [19-20](#)

18. 10 Nm

19. Vibration damper

- Assembly on the sprocket/crankshaft only possible in one position: The lug on the sprocket must engage in the bore of the belt pulley
- Removing and installing=>Page [13-12](#)

20. 20 Nm

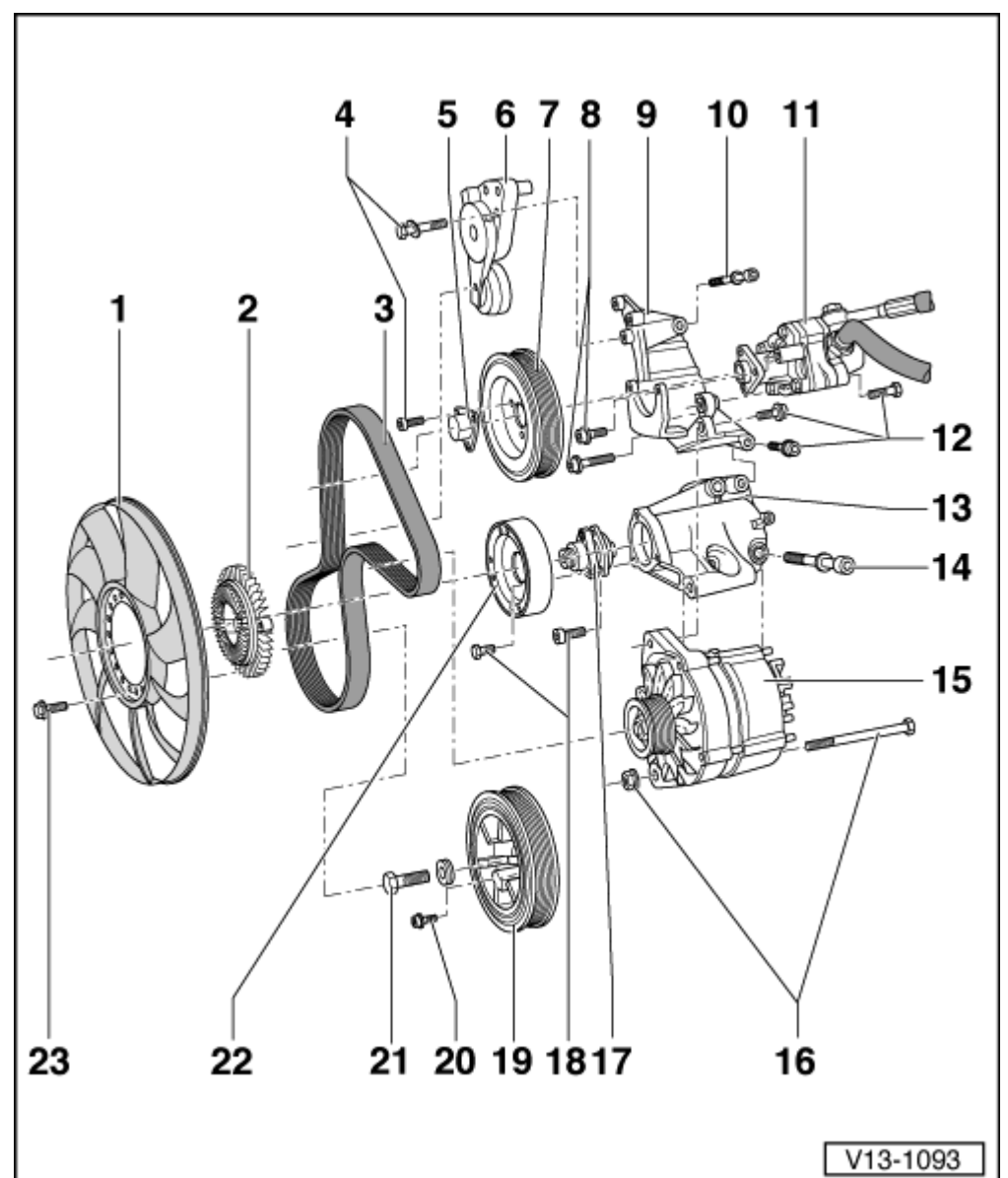

21. Central bolt

- Replace
- Coat thread and contact surface of bolt head with sealing paste
- Sealing paste

=> Parts List

- Counter hold with 3256 to loosen and tighten
- Tightening torque 200 Nm + 270°(3/4 turn)
- Removing and installing=>Page [13-12](#)

**22. Belt pulley**

For viscous fan

Removing and installing =>Page [19-20](#)

**23. 10 Nm**

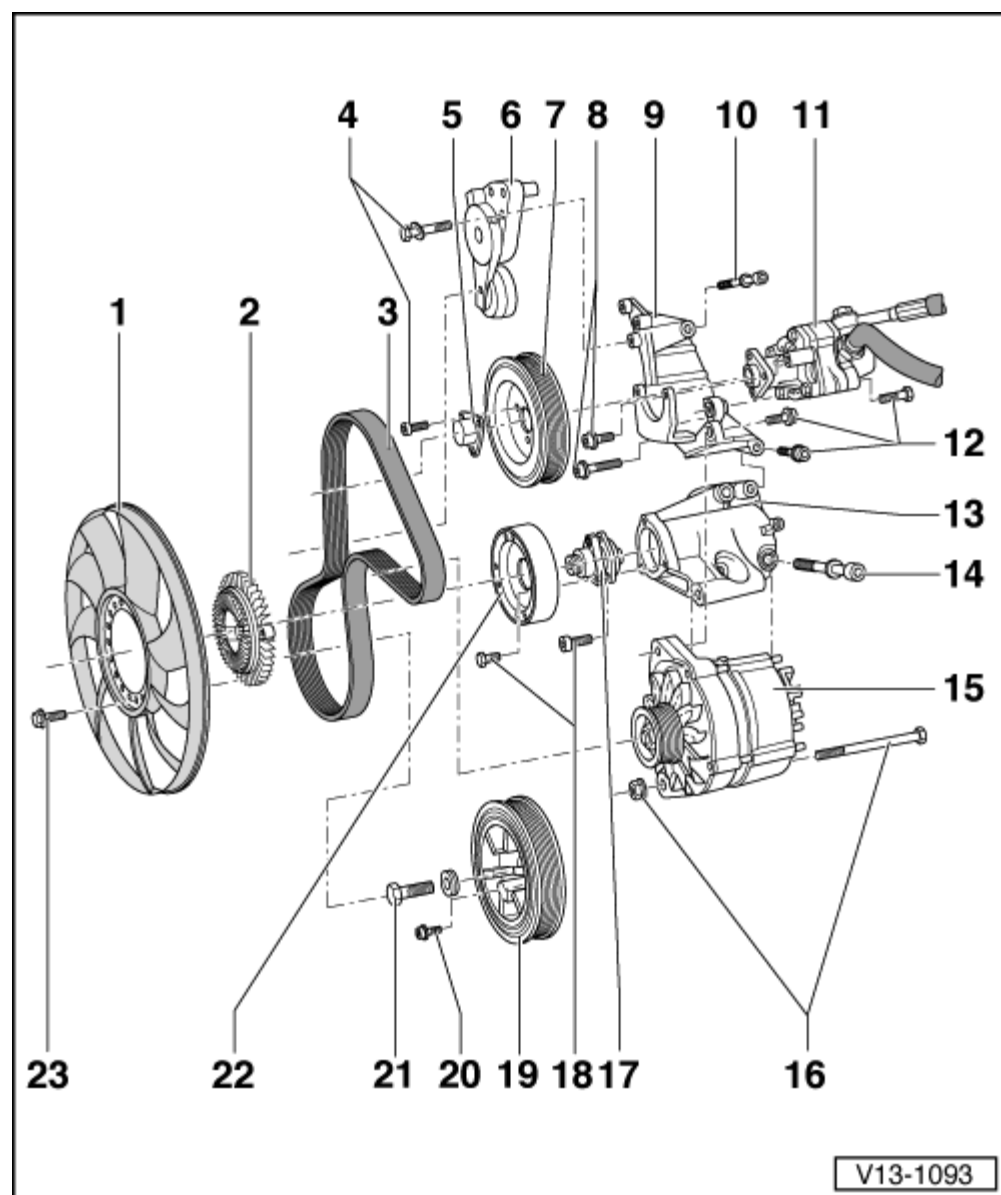

V13-1093

→ Fig.1 Ribbed belt routing on vehicles without air conditioner

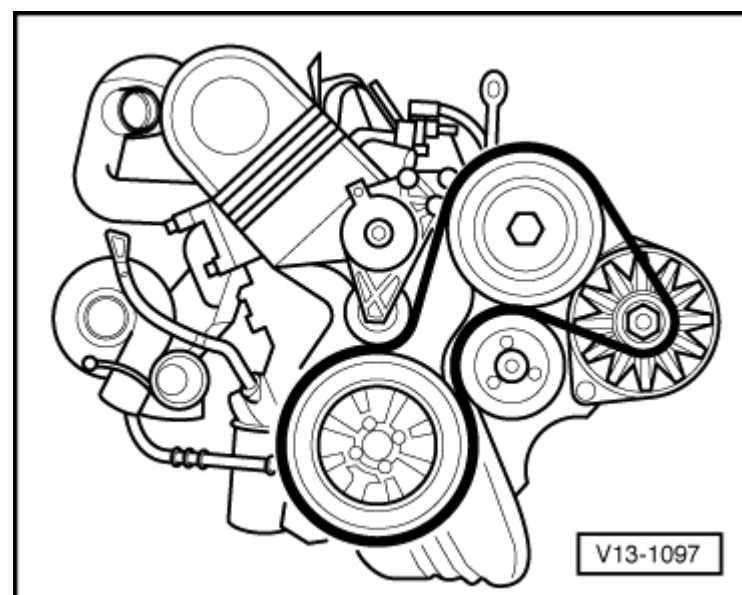

V13-1097

→ Fig.2 Ribbed belt routing on vehicles with air conditioner

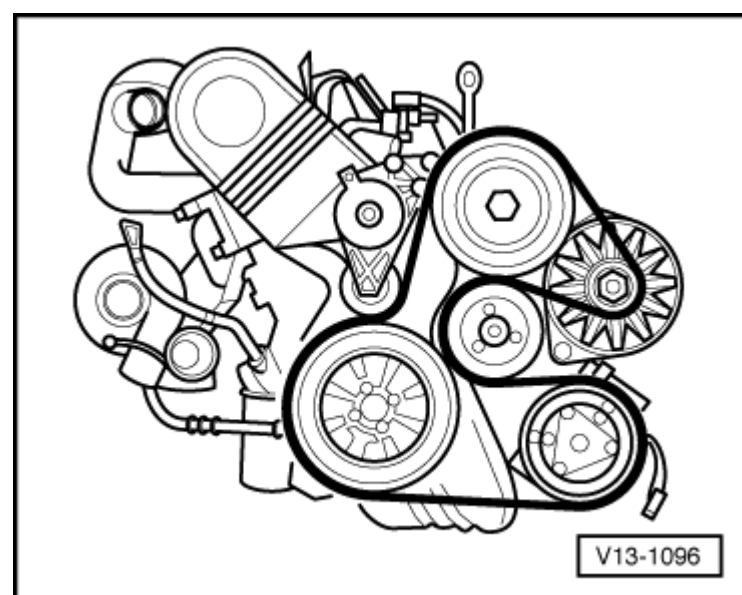

V13-1096