

Removing and installing rear lid trim (bottom)

Special tools and workshop equipment required

t Front-end hook -3370-

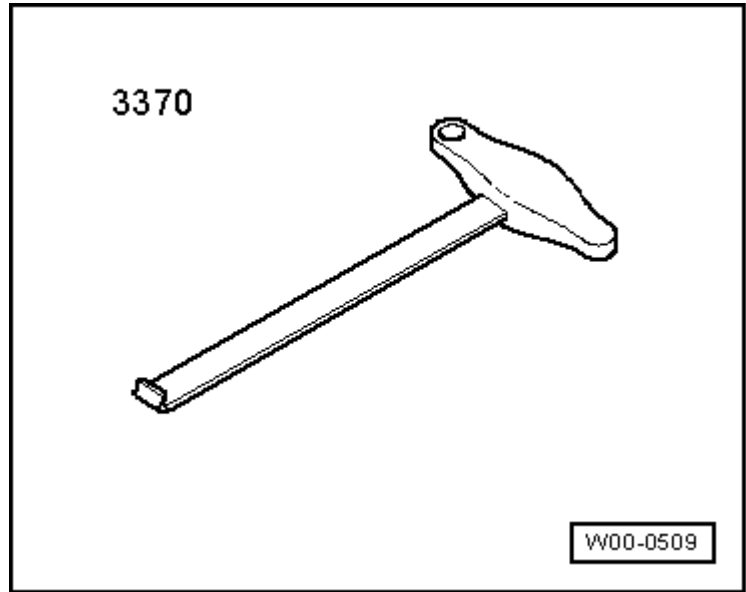

1 - Luggage compartment light

q Removing and installing
→ [Electrical system](#); Rep. Gr.96

2 - Bolts (4x)

q Tightening torque:
1.5 Nm

3 - Rear lid trim (bottom)

- t Removing:
- Open flap for warning triangle and detach warning triangle.
 - Unscrew bolts -2- (4x).
 - Disengage fasteners (left and right) at top of trim using front-end hook -3370- → [Fig.](#)
 - Carefully pull spring clips -4- of trim at bottom right

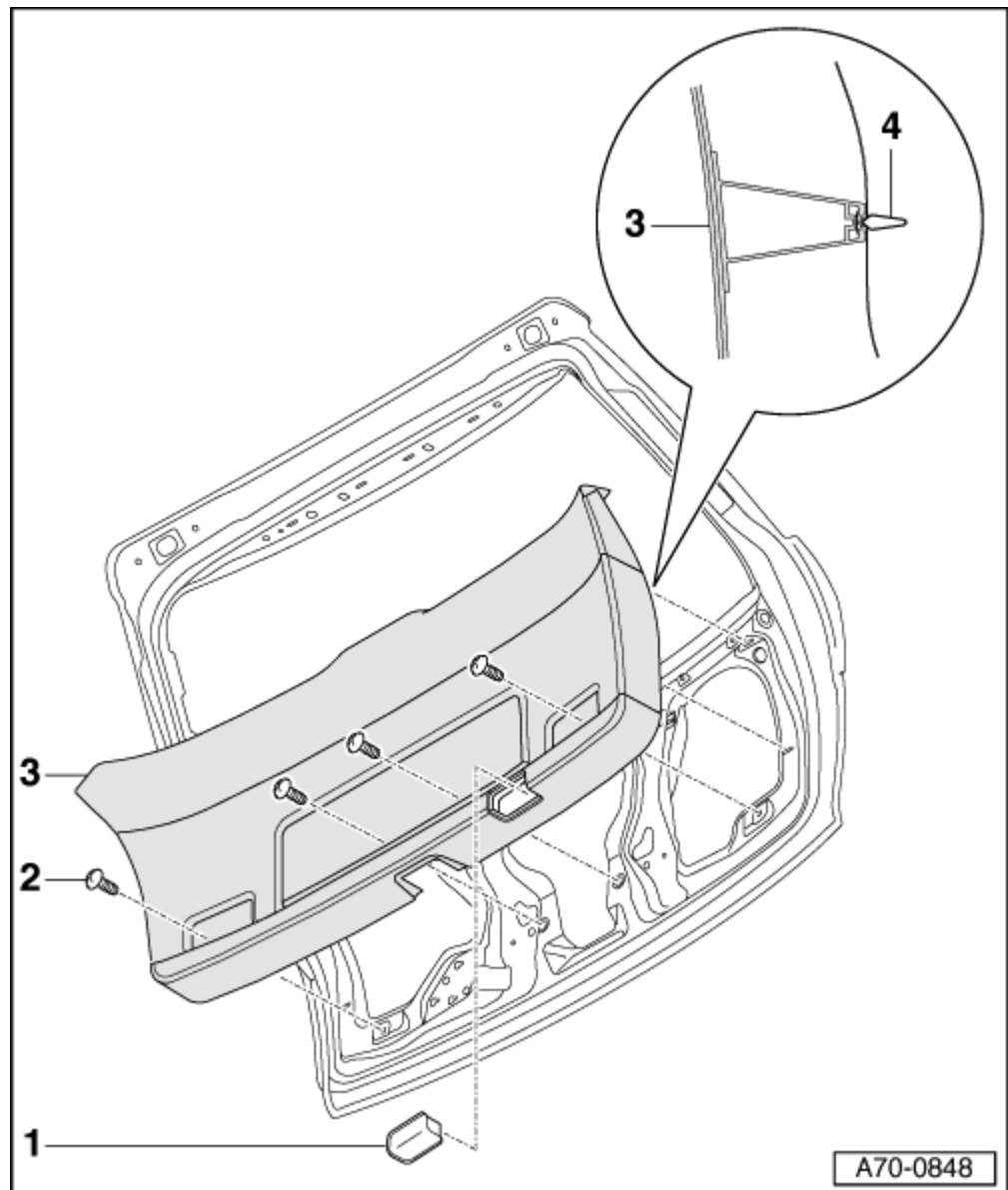

and left out
of rear lid.

- Reach between trim and rear lid and disengage four more spring clips -4-.
- Detach trim.

⌚ Installing:

Install in reverse order of removal. Observe the following:

- Make sure trim engages in trim panel at rear lid lock.



Caution
Make sure trim is properly secured.

4 - Spring clips (6x)

Disengaging trim (bottom) from fastener

- Disengage fastener (left and right) at top of trim using front-end hook -3370--arrow-.

