

## Removing and installing front bumper

### Special tools and workshop equipment required

- ♦ Socket -T 40078-
- ♦ Make use of socket -T 40078- for screwing in cap nuts at wing mounting flange.

**Exploded view: Up to vehicle ident no. 400 000**

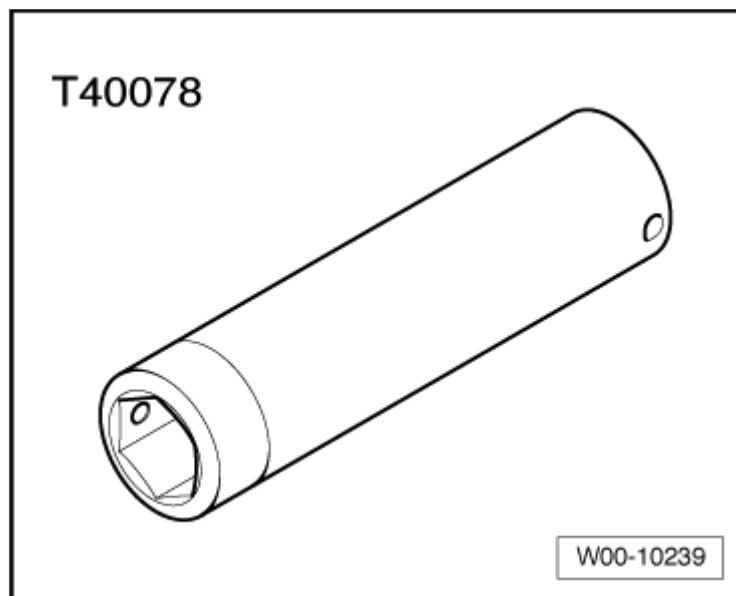

#### 1 - Hexagon socket-head bolt

- 26 Nm

#### 2 - Air inlet grille

- Removing, S4 → Fig.

#### 3 - Locking pin

- To remove turn 180°.

#### 4 - Bumper guard

- Renew
- The bumper guards are attached to the bumper with double-sided adhesive tape.
- Is destroyed when removed.
- To remove, pull bumper guard off bumper.
- Remove any remaining adhesive from bumper.
- Installation

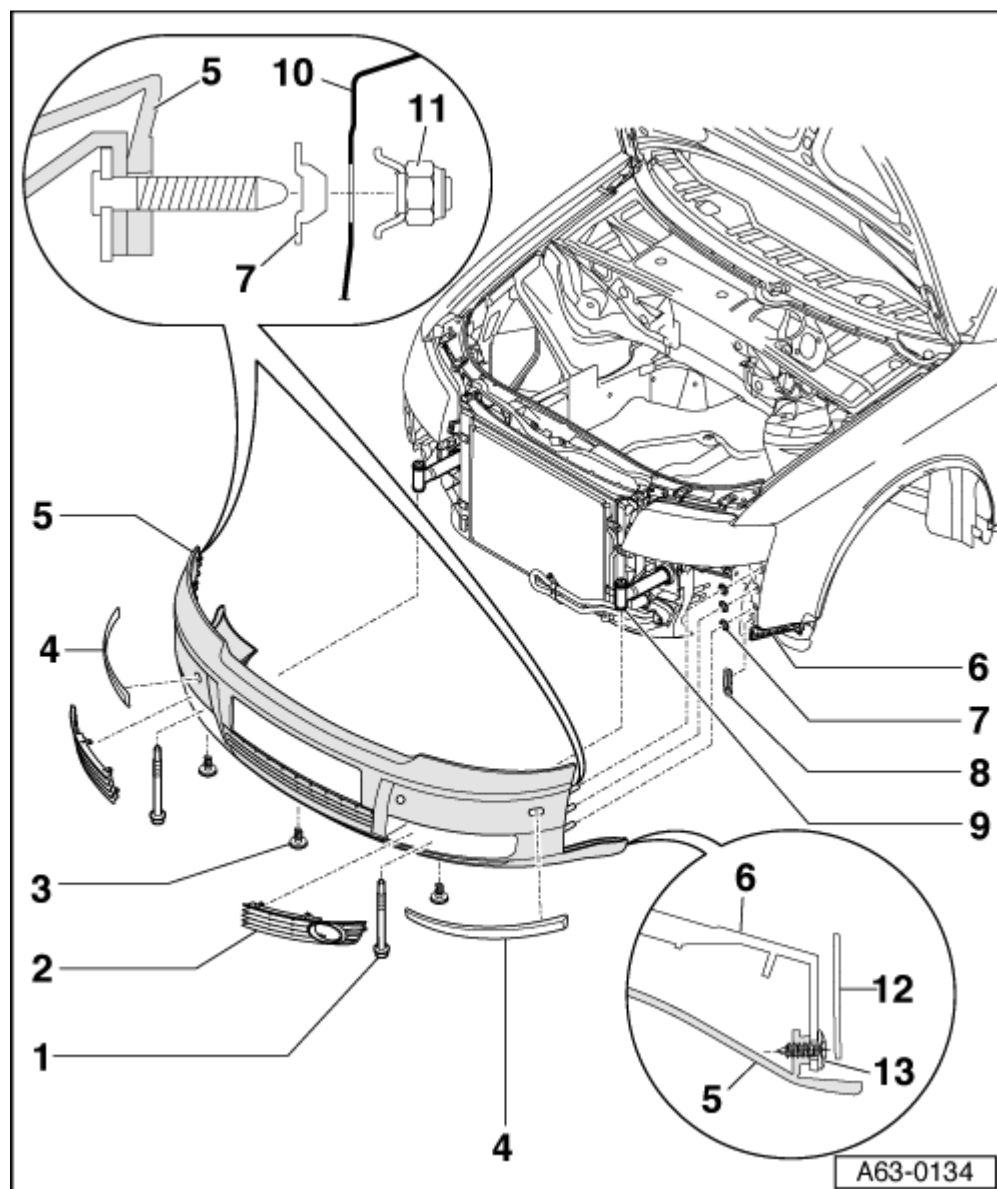

on the same  
bumper:

- ❑ Bumper must be free from dust and grease in bonding area.
- ❑ Clean bumper with cleaning solvent or cleaning fluid D 009 401 04.



#### Note

*Bumper is already provided with centring holes for centralising pins so that bumper guards can be fitted in correct position.*

- ❑ Position centralising pins with double-sided adhesive tape on marks on bumper guard → Fig.
- ❑ Pull backing off double-sided adhesive tape of bumper guard.
- ❑ Firmly press entire area of bumper guard with bonded-on centralising pins onto bumper.
- ❑ Installation on a new bumper:



#### Note

*Centring holes for bumper guard must be drilled into new bumper BEFORE it is painted.*

- ❑ Make centring holes for bumper guards on bumper → Chapter.
- ❑ Fit bumper guard onto bumper as described above.

### 5 - Bumper

- ❑ With cross member
- ❑ Removing and installing bumper → Chapter
- ❑ Removing and installing cross member → Chapter
- ❑ Separating two-piece bumper cover → Chapter
- ❑ Making number plate attachment holes → Fig.

### 6 - Guide

- ❑ Removing and installing → Chapter

### 7 - Expanding clip

- ❑ 6x
- ❑ Must be inserted in wing before fitting bumper cover

### 8 - Grommet

- ❑ 2x
- ❑ Must be inserted in wing before installing bumper cover

### 9 - Impact absorber

- ❑ Self-adjustment of height with respect to cross member → Chapter

### 10 - Wing

### 11 - Special nut

- ❑ 4 Nm

### 12 - Wheel housing liner

### 13 - Bolt

- ❑ 1 Nm
- ❑ 2x

## Exploded view: As of vehicle ident no. 400 001

### 1 - Bolt with washer

- ❑ 6 Nm

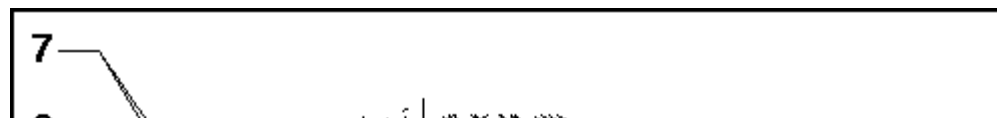

**2 - Hexagon socket head bolt**

- 23 Nm

**3 - Bumper**

- Bumper cover removed.
- To remove, unscrew hexagon socket head bolts -2-.
- Unplug connectors for horns and detach bumper from impact dampers, pulling it forwards.

**4 - Pop rivet****5 - Signal horn**

- Drill off rivet heads to remove.

**6 - Support****Note**

*Make sure support bracket extends on screwing in adjusting screw*

- Before fitting bumper cover, adjust adjusting screw of support → Fig.
- Tighten adjusting screw with a long Torx wrench -T 30- through holes in cover -arrows- to 2 Nm.
- To remove, drill off pop rivet heads.

**7 - Pop rivet****8 - Signal horn****9 - Brace for wing panel****10 - Guide**

- Side section of bumper cover must be clipped in between wing and guide → Fig..

**11 - Torx bolt**

- 1 Nm

**12 - Combi bolt**

- 1 Nm

**13 - Bumper cover****Note**

*When installing, make sure you adhere to the correct sequence for installation and tightening as specified below.*

- Position cover on vehicle and clip side sections (left and right) into guides -10-.
- Tighten cap nuts at wing mounting to 4 Nm → Fig..
- Tighten bolts -12- at wheel housing liner.
- Lightly screw in bolts -1-.
- Close bonnet and check whether cover is recessed or protrudes.
- If necessary, correct position of cover and tighten bolts -12- to 6 Nm.
- Tighten bolt at support to 2 Nm → Fig..
- Removing and installing bumper → Chapter
- Removing and installing cross member → Chapter

**Exploded view for RS 4****Note**

- ♦ *Removal and installation are performed as for the standard bumper as of vehicle ident no. 400 001.*

♦ Only the differing operations are described.

### 1 - Combi bolt

- 6 Nm

### 2 - Bumper cover

- Removal and installation as for standard version.



**Note**

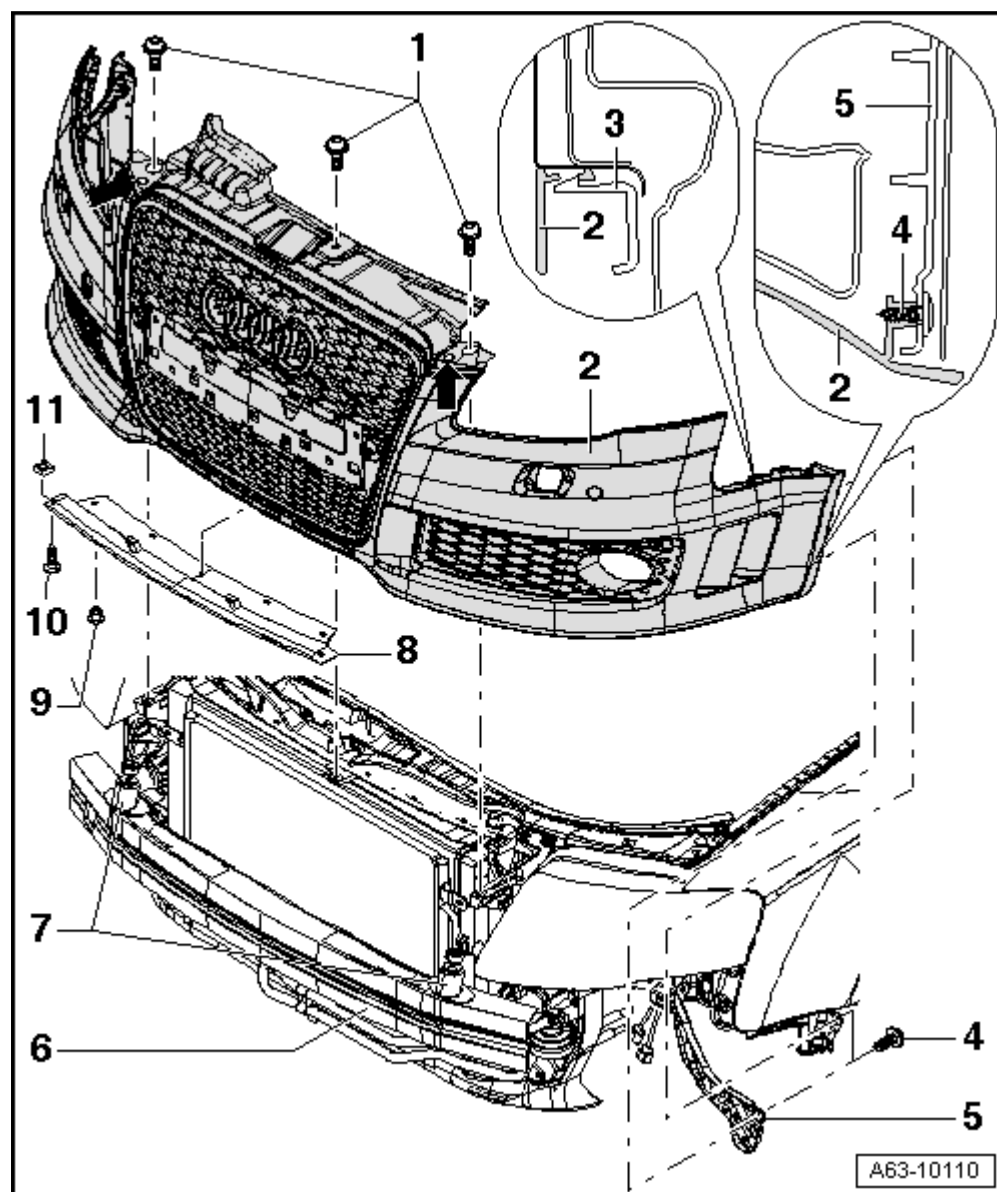

*On installation, the assembly/attachment sequence described below must be observed to ensure correct fitting.*

- Position cover at vehicle and first clip the left and right side sections into the guide elements -10-.
- Tighten the cap nuts at the wing mounting flange to 4 Nm → Fig..
- Tighten bolts -12- at wheel housing liner.
- Loosely screw in bolts -1-.
- Close bonnet and check alignment of cover.
- Correct position of cover if necessary and tighten bolts -12- to 6 Nm.
- Tighten bolt at support to 2 Nm → Fig..
- Removing and installing bumper → Chapter
- Removing and installing cross member → Chapter

### 3 - Guide element

### 4 - Torx bolt

- 1 Nm

### 5 - Wing brace

## 6 - Bumper

## 7 - Support



### Note

*Make sure support bracket extends on screwing in adjusting screw*

- ❑ Before fitting bumper cover, adjust adjusting screw of support → Fig.
- ❑ Tighten adjusting screw with a long Torx wrench -T 30- through holes in cover -arrows- to 2 Nm.
- ❑ To remove, drill heads off pop rivets.

## 8 - Front spoiler

- ❑ Unscrew bolts -10-
- ❑ Slide spoiler slightly to rear out of guides in bumper cover.
- ❑ Detach spoiler downwards.

## 9 - Expanding rivet

## 10 - Combi bolt

- ❑ 2 Nm

## 11 - Speed nut

### Wing mounting

- When installing, make sure that clips -2- are fitted on studs.
- After fitting bumper cover -1- onto wing -3- tighten cap nuts -4- to 4 Nm.

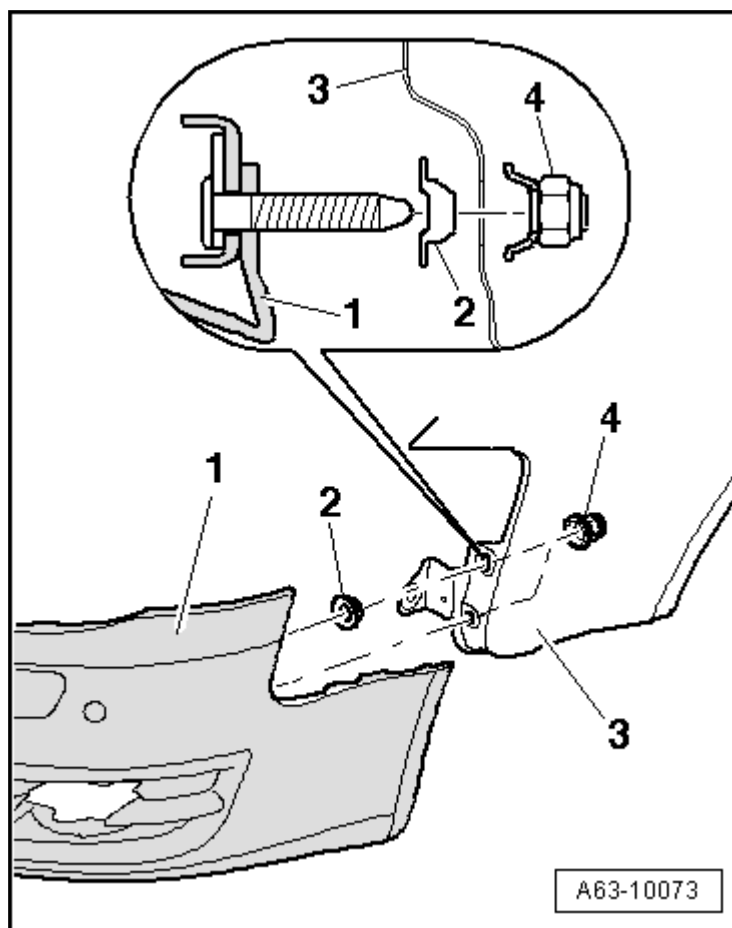

### Adjusting support



### Note

- ♦ *Make sure support bracket -4- extends on screwing in adjusting screw -3-.*

- ♦ *If support bracket does not extend, apply a small droplet (tiny amount ) of locking fluid "D 000 600 A2" to thread of adjusting screw -3- and allow locking fluid to harden.*
- ♦ *Screw in adjusting screw as far as dimension -a-.*
- ♦ *The increased friction causes the support bracket to extend on screwing in the adjusting screw.*
- Before installing bumper cover -1- set adjuster screw -3- on support -5- so that dimension -a- = 21 mm + 1 mm.
- The support element -4- must be screwed in completely (left-hand thread).
- The adjusting screw -3- and support bracket -4- are part of the scope of delivery of the support and are not replacement parts.
- When screwing in bolt -3-, support element -4- unwinds and then holds support -2- for bumper cover -1- in specified position.
- Support -5- is secured to bumper -6- with pop rivets.

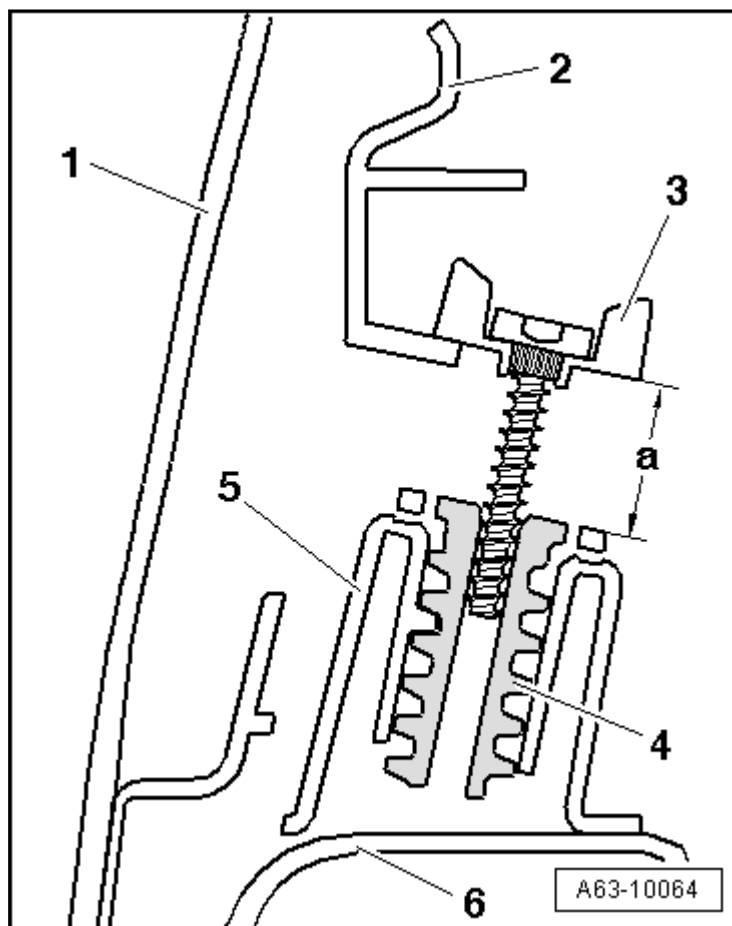

### Clamping pins for noise insulation

- When removing bumper cover -1-, turn clamping pins -2- 180° and pull them out of speed nut -4- on noise insulation -3-.

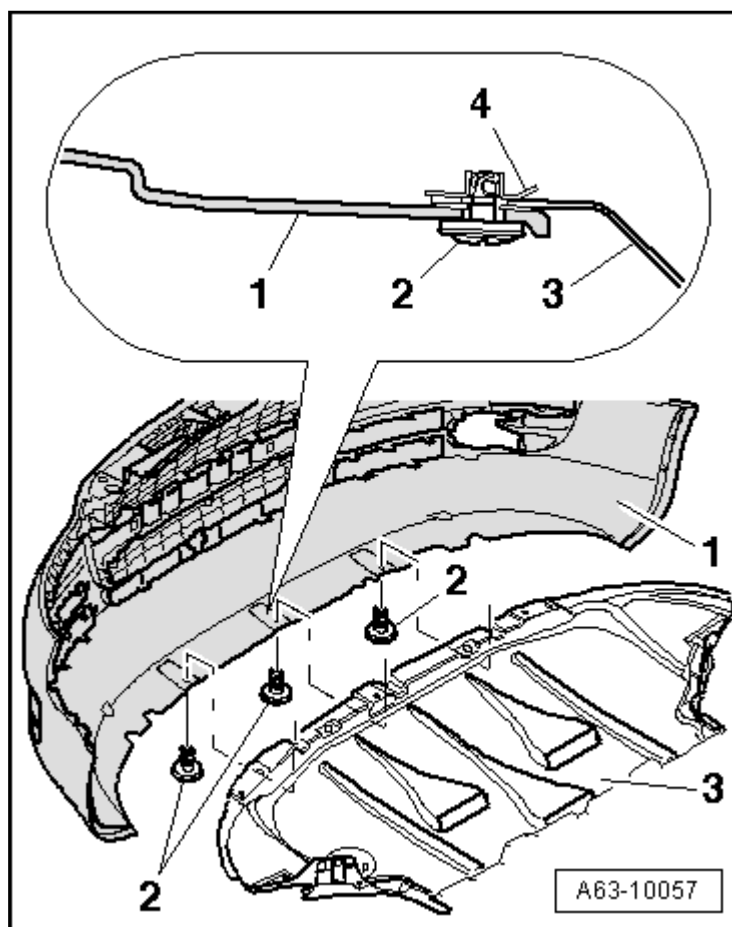

### Removing guide

- Bumper cover removed.
- Unscrew bolts -3- and detach guide -2- downwards out of wing -1-.
- When installing, bumper cover -4- must engage correctly in guide.

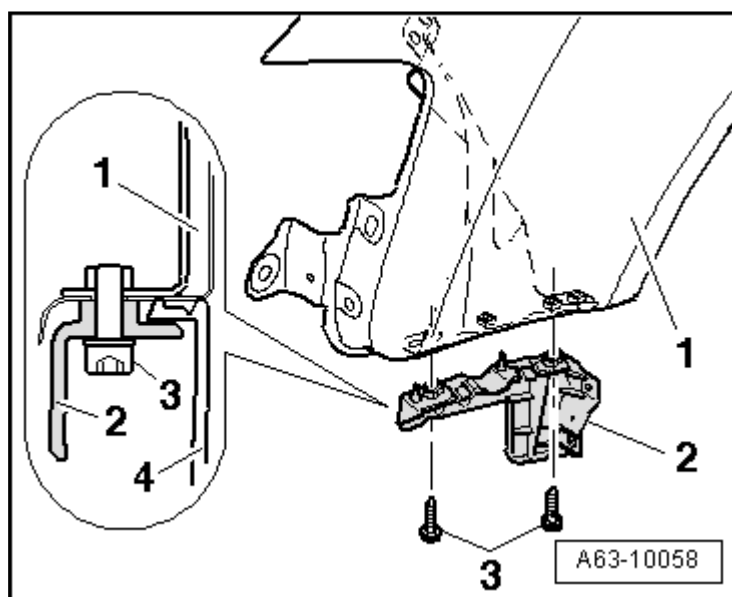

### Brace for wheel housing liner

- To secure wheel housing liner (front) -3-.
- When installing brace -1- tighten bolt -2- to 10 Nm.

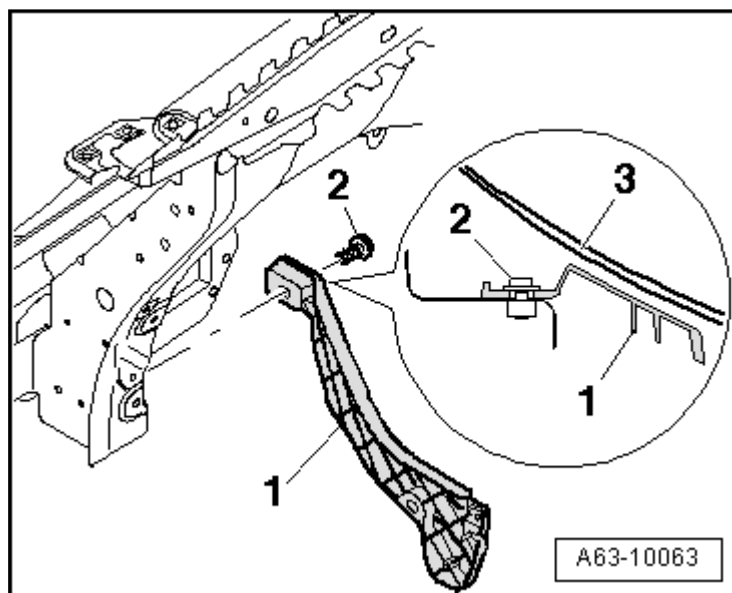

### Air inlet grille for S4

- Unscrew cross-head bolt -arrow-.
- On inside of bumper cover -2-, press air inlet grille -2- to rear out of retainer as shown.
- Detach air inlet grille to front out of bumper cover.

