

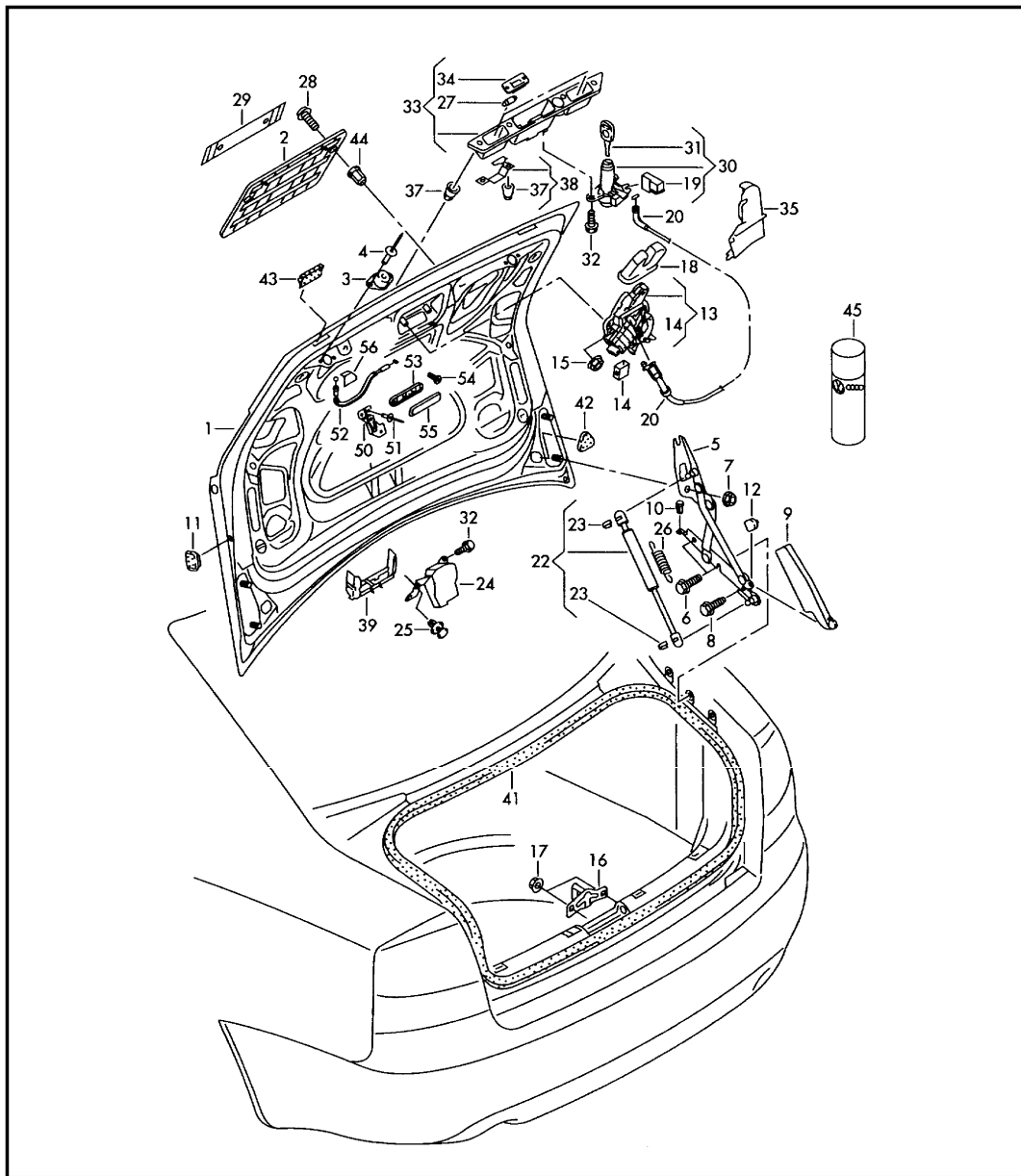

Model	Year	MG	SG	Illustration	Restrictions	UPD	16:19	28.11.201		ETKA
A4	2007	8	27	827-00		799				



Pos	Part Number	Name	Remarks	Qty	Model
		flap	rear		sedan
(1)	8E5 827 023 AA	rear trunk lid	also use: **>>8E-6-175000	1	PR-6V1+5J0
		stop	8E5 827 797 A	2	
(1)	8E5 827 023 AB	trunk with intergrated spoiler	also use: >>8E-6-175000	1	PR-6V1+5J2
		stop	>>8E-6-800875	2	PR-6V1+5J1
		stop	8E5 827 797 A	2	
(1)	8E5 827 023 AC	rear trunk lid	also use: **>>8E-6-175000	1	PR-6V6, 6V2+5J0
		stop	8E5 827 797 A	2	
(1)	8E5 827 023 AD	trunk with intergrated spoiler	also use: **>>8E-6-175000	1	PR-6V6, 6V2+5J1+5J2
		stop	8E5 827 797 A	2	
(1)	8E5 827 023 L	rear trunk lid F	>> 8E-6-175 000*	1	PR-6V3+5J0
(1)	8E5 827 023 AE	rear trunk lid F	8E-6-175 001>>*	1	PR-6V3+5J0
		stop	also use: **>>8E-6-175000	2	
		stop	8E5 827 797 A	2	
(1)	8E5 827 023 Q	trunk with intergrated spoiler F	>> 8E-6-175 000*	1	PR-6V3+5J2
(1)	8E5 827 023 AF	trunk with intergrated spoiler F	8E-6-175 001>>*	1	PR-6V3+5J2
		stop	also use: **>>8E-6-175000	2	
		stop	8E5 827 797 A	2	
-	8T0 827 199	retaining ring	rear	1	PR-6V3
2	8E0 827 113 C	trim for licence plate		1	PR-6V6
		black			
	11/04-06/081P9				
(2)	8E0 827 113 B	trim for licence plate		1	PR-6V2
		black			
	11/04-06/081P9				
3	8E5 827 249 F	buffer, adjustable		2	PR-4E0, 4E2
(3)	8E5 827 249 G	buffer, adjustable		2	PR-4E0, 4E2+ E9A
(3)	8E5 827 249 G	buffer, adjustable		2	PR-4E5
4	N 016 202 3	rivet	4X8	4	

Model	Year	MG	SG	Illustration	Restrictions	UPD	16:19	28.11.201		ETKA
A4	2007	8	27	827-00		799				

Pos	Part Number	Name	Remarks	Qty	Model	Pos	Part Number	Name	Remarks	Qty	Model
(5)	8E5 827 301 G	flap hinge	left	1	PR-4E0	29	8D0 853 419 D	packing, adhesive shorten if necessary	2,5MM	1	PR-6V1,6V3
(5)	8E5 827 302 G	flap hinge	right	1	PR-4E0	30		see illustration, item:	837-10,2		
(5)	8E5 827 301 H	rear lid hinge	left	1	PR-4E5	31		see illustration, item:	837-10,3		
(5)	8E5 827 302 H	rear lid hinge	right	1	PR-4E5	32	8E0 827 654 A	attachment bolt	5X33	1	
6	N 906 309 03	bolt,hex.hd.with shoul.(combi)	M8X20	4		33	8E0 827 574 C	grip molding	plastic	1	
7	N 903 484 11	hex. nut with washer	M8	4			11/04-06/083FZ	black			
8	8E0 827 409	fitted bolt	M8X20X24	2		34		license plate light see illustration, item:	945-60,1		
9		wiring conduit see illustration:	971-80			35	4E0 827 645 A	protective cap	inner upper	1	"GB."
10	8D5 827 499	stop	left a. right	2		(37)	8E0 827 657 F	retainer	inner	2	
11	8E5 827 373	stop	left a. right	2		38	8E0 827 657 D	securing sleeve F >> 8E-7-045 519 F >> 8E-7-801 000	left	1	
12	8E5 827 378	stop	right	1		(38)	8E0 827 657 G	retainer F 8E-7-045 520>> F 8E-7-801 001>>	left	1	
13	4F5 827 505 D	trunk latch		1		(38)	8E0 827 657 E	securing sleeve F >> 8E-7-045 519 F >> 8E-7-801 000	right	1	
15	N 015 082 10	shouldered hex. nut	M6	2		(38)	8E0 827 657 H	retainer F 8E-7-045 520>> F 8E-7-801 001>>	right	1	
16	4F5 827 507 B	striker		1							
17	N 905 708 02	hex. nut with washer	M6	2							
18	4E0 827 520 B	cover - lock		1							
	11/04-06/0801C	satin black									
19	8E0 953 229	micro switch		1		39	8E5 827 569	protective cap	lower	1	"GB."
20	8E5 827 531 D	cable - hood latch		1		41	8E5 827 705 L	decklid weatherstrip		1	
22	8E5 827 552 J	gas-filled strut	left a. right	2	PR-4E0,4E2	42	8E5 827 976	grommet		1	
(22)	8E5 827 552 K	gas-filled strut	left a. right	2	PR-4E5	43	8E5 827 797 A	stop	left a. right	2	PR-K8B
23	443 823 397	clamp		4		44	N 906 481 02	rivetted cap nut	M6X0,8-3	2	
23	443 823 397	clamp		4							
24	8E5 827 597	protective cap		1	"GB."						
25	4Z7 853 934	rivet		1	"GB."						
26	4F5 827 665 A	spring		2	PR-4E5						
27		bulb contained in key:	40								
28	N 104 065 04	oval hexagon socket head bolt	M6X12	1							